

INSTRUCTION MANUAL

KOBRA EB - KOBRA SH



EN

Instruction manual
(Original instruction)



Attention: Read the instruction before use
the machine



CONTENT INDEX

PRESENTATION	4
ATTENTION!	4
MACHINE IDENTIFICATION	5
WARNINGS AND RECOMMENDATIONS	6
GENERAL WARNINGS AND ADVICE	6
DISPOSAL	7
PICTURE DESCRIPTION	8
USE OF MACHINE	10
DRIVE	10
PARKING BRAKE	10
RELEASE BRAKE	10
CLEANING THE FILTERS.....	10
VACUUM CUT-OFF	10
"HONDA" MOTOR	10
ELECTRIC MOTOR	11
PERIODIC MAINTENANCE	11
REPLACING THE FILTER.....	11
MAIN BRUSH ADJUSTMENT	11
REPLACEMENT OF MAIN BRUSH.....	11
TECHNICAL CHART SH	12
TECHNICAL CHART EB	13
TROUBLESHOOTING TABLE	14
SERVICE AND MAINTENANCE RECORDS	15

PRESENTATION

Our company, a leader in the production of industrial cleaning machines, is delighted to have you among the owners of this sweeper and is sure you will be fully satisfied with it. We are sure that during its use, you will see the quality, robustness and possibilities of use it has to offer. This sweeper is suitable for private, industrial or public use. This manual describes the various installation operations, controls and maintenance interventions necessary to maintain perfect efficiency of your sweeper. These are normal maintenance operations that any operator can carry out using devices normally available in a company. For particular works, please contact specialist staff.

OUR COMPANY AIMS TO CONSTANTLY IMPROVE ITS PRODUCTS AND RESERVES THE RIGHT TO MAKE CHANGES AND IMPROVEMENTS WHEN NECESSARY WITHOUT ANY OBLIGATION TO UPGRADE PREVIOUSLY SOLD MACHINES.

ATTENTION!

BEFORE USING THE MACHINE OR CARRYING OUT ANY OPERATION ON IT, ALL THE PROCEDURES AND WARNINGS DESCRIBED IN THIS MANUAL MUST BE READ AND UNDERSTOOD. STRICT COMPLIANCE WITH THE REGULATIONS AND THE INSTRUCTIONS CONTAINED IN THIS MANUAL, COMBINED WITH THE OPERATOR'S ATTENTION AND CAUTION, WILL BE THE BEST GUARANTEE AGAINST ACCIDENTS THAT CAN OCCUR IN THE WORKPLACE.

SWEEPERS ARE DESIGNED TO PROVIDE UTMOST SAFETY IF USED ACCORDING TO INSTRUCTIONS.

THIS MACHINE IS INTENDED FOR COMMERCIAL USE, FOR EXAMPLE IN HOTELS, IN SCHOOLS, IN HOSPITALS, IN FACTORIES, IN SHOPS, IN OFFICES AND IN BUSINESSES.

THIS MACHINE IS NOT INTENDED FOR USE BY PEOPLE (INCLUDING CHILDREN) WITH REDUCED PHYSICAL, SENSORY OR PSYCHOLOGICAL CAPACITY, OR WITH LACK OF EXPERIENCE AND KNOW-HOW. CHILDREN SHOULD BE MONITORED TO ENSURE THEY DO NOT USE THE EQUIPMENT TO PLAY ON.

THE USER MANUAL IS AN INTEGRAL PART OF THE SWEEPER AND MUST ACCOMPANY IT UP TO ITS DEMOLITION.

PURSUANT TO DIRECTIVE 2006/42 EC, AND DPR 459 ON 24/07/1996 AND SUBSEQUENT UPDATES, IT IS MADE KNOWN THAT: OPERATOR IS INTENDED AS THE PERSON OR PEOPLE RESPONSIBLE FOR INSTALLING, OPERATING, ADJUSTING, CARRYING OUT ROUTINE MAINTENANCE, CLEANING, REPAIRING AND TRANSPORTING THE MACHINE.

THIS COMPANY CANNOT BE HELD LIABLE FOR PROBLEMS, BREAKAGES, ACCIDENTS OR OTHER ISSUES DUE TO LACK OF KNOW-HOW OR NON-APPLICATION OF THE PROCEDURES CONTAINED IN THIS MANUAL, OR DUE TO IMPROPER USE OF THE MACHINE.

THIS COMPANY ALSO CANNOT BE HELD LIABLE FOR CHANGES, INSTALLATION OF PARTS AND/OR ACCESSORIES WITHOUT PRIOR AUTHORISATION.

MACHINE IDENTIFICATION

The machine and manufacturer are identified through three plates on the rear of the dirt container



REFER TO THESE DETAILS WHEN ORDERING SPARE PARTS OR MAKING ANY OTHER ENQUIRY TO THE MANUFACTURER.

The sweepers conform with the EEC directives and show the CE mark

WARNINGS AND RECOMMENDATIONS

- The sweeper is designed to carry out the cleaning of dry floors;
- **To avoid unpermitted use of the machine, the power supply must be interrupted, to do this remove the ignition key;**
- Do not use for toxic powders;
- Do not use in an explosion risk area;
- Do not collect materials that could cause a fire (f.e. cigarette butts hot weldibgs rod ends)
- Be aware of other members of staff in the sweeping area;
- Never leave the sweeper with the engine running. Turn the engine off and remove the key;
- Never open the protective covers when the sweeper is running;
- Maintenance operations should only be carried out with the engine turned off;
- Unguarded machines must be protected from unintentional movements, use the parking brake;
- This machine must be used only in closed places;
- Do not attempt to work on slopes whose gradients exceed the value shown on the table;
- Do not use the machine for the cleaning of large objects;
- The main brush must not sweep up wires, ropes, or any other long material that may get tangled with it;
- Do not carry out any modification to the machine without our previous agreement;
- The sweeper has not been approved for use on the public highway;

UPDATING OF THE USER'S MANUAL

When large-scale modifications are made to the machine or new parts are installed, the updated documentation must be sent to the Dealer along with the purchased part or as an update of the manual.

OBLIGATIONS OF THE EMPLOYER OR OWNER OF THE MACHINE

The employer or owner of the machine is responsible for giving the User's Manual to all the personnel who are going to have to use the machine.

The employer or owner of the machine also undertakes to update the manual with the documentation that the Manufacturer will send if modifications are made to the machine.

GENERAL WARNINGS AND ADVICE



WARNING: very hot surfaces



WARNING: Use adequate acoustic protection.

In a few working environments, sweepers might generate an acoustic danger which can be eliminated with adequate acoustic protection.



EMERGENCY SITUATIONS

**IN THE EVENT OF FIRE, ONLY USE POWDER EXTINGUISHERS
IF OCCURS ANY ABNORMAL BEHAVIOR (UNCONTROLLED SPEED INCREASE,
OVERHEATING, ...) TURN OFF THE MACHINE IMMEDIATELY**

DISPOSAL



All packaging is recyclable. The packaging should not be thrown away with domestic waste, but sent to the relevant collection centres.



EXHAUSTED OIL

Exhausted oil must never be disposed of in the environment.

It must be sent to authorised collection companies, in compliance with legislation in force.



Temporary storage must be in airtight containers, fitted with a sealed lid, to avoid contact with the environment and rainwater.

Filters should also be delivered to authorised collection companies and temporarily stored following the same procedures applied to the storage of oil.



EXHAUSTED LEAD-ACID BATTERIES

Exhausted batteries are considered harmful toxic waste and therefore should be exclusively given to collection companies with specific authorisation (ascertain on hand-over).

MATERIAL COLLECTED FROM THE MACHINE

The waste collected by the machine must be given to the relevant urban cleaning company since it is considered urban waste or similar.

The machine cannot be used to collect toxic-harmful materials.

SCRAPPING THE MACHINE

On scrapping, proceed with the correct disposal of the materials that make up the machine. It is compulsory to give the machine to authorised collection companies which will correctly dispose of oil, filters, plastic, metal, electric motors, electric boards, etc. in compliance with legislation in force. Decommissioned equipment contains precious recyclable materials and therefore should be given to the relevant collection centres.

Please dispose of decommissioned equipment through differentiated collection systems.



DISPOSAL OF ELECTRICAL EQUIPMENT AND ELECTRONICS



PICTURE DESCRIPTION

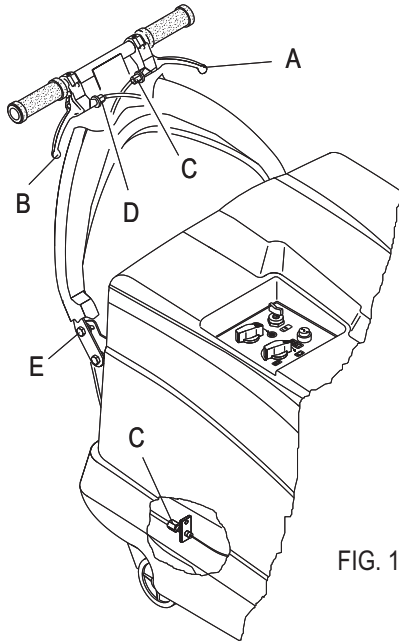

FIG. 1

FIG.1

- A. Traction lever
- B. Flap lever
- C. Traction adjustment screw
- D. Flap lever adjustment screw
- E. Handle adjustment screw

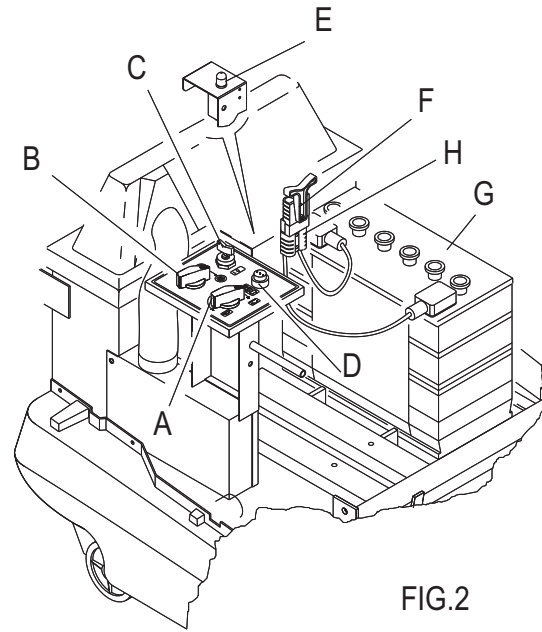

FIG.2

FIG.2 ELECTRIC VERSION

- A. Side brush handle
- B. Vacuum cut-off handle
- C. Keyswitch
- D. Low battery charge warning light
- E. Cut out switch 50Ah
- F. Motor connector
- G. Battery
- H. Fixed battery connector

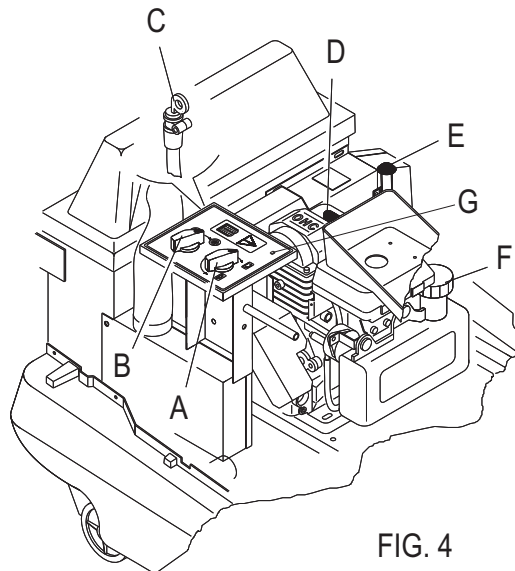

FIG. 4

FIG.4 HONDA VERSION

- A. Side brush handle
- B. Vacuum cut-off handle
- C. Oil level rod
- D. Motor spark plug
- E. Oil exhaust hose
- F. Gasoline tank cup
- G. Switching off button

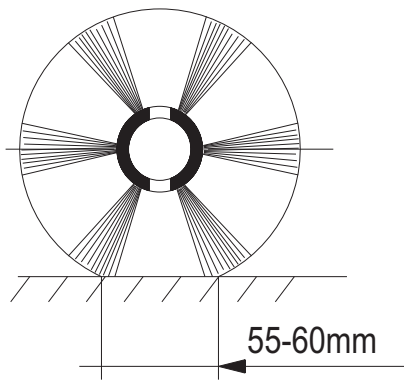

FIG. 5

FIG.5

Clean path

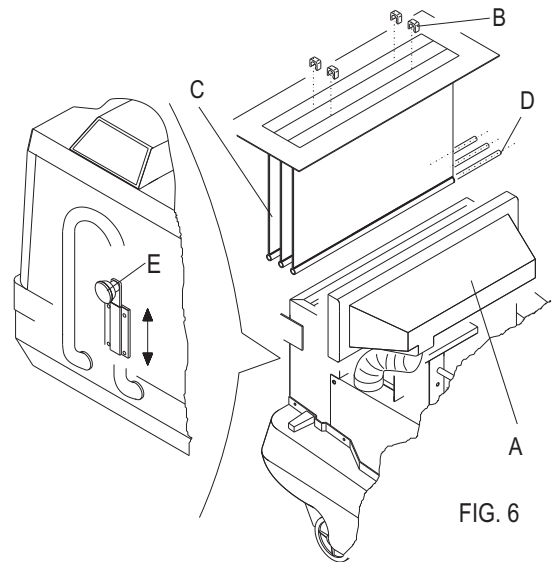

FIG. 6

FIG.6

- A. Filter cover
- B. Clamp
- C. Bag filter
- D. Steel bar
- E. Filter shake lever

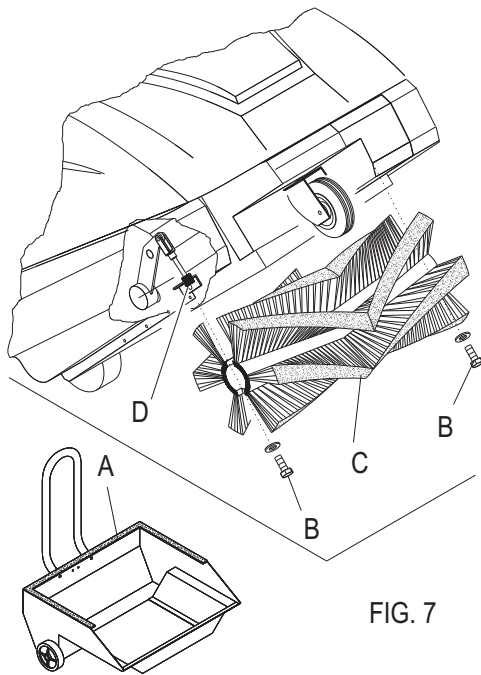

FIG. 7

FIG.7

- A. Dirt container
- B. Main brush blocking screw
- C. Main brush
- D. Main brush pressure adjustment screw

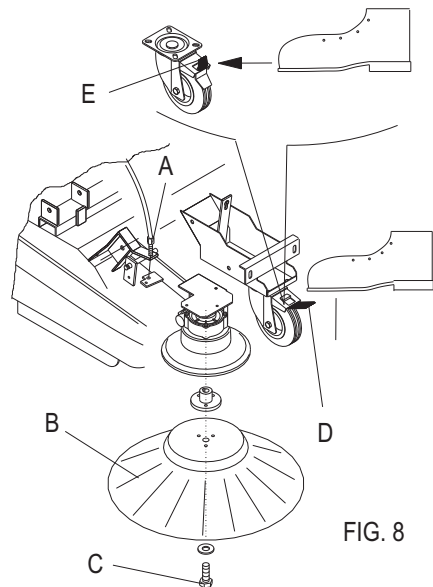

FIG. 8

FIG.8

- A. Side brush adjustment screw
- B. Side brush
- C. Side brush blocking screw
- D. Front wheel brake lever
- E. Unblocking brake lever

USE OF MACHINE

DRIVE

The mechanical traction is engaged by pulling the lever (pic.1 pos.A) from the handle.

Note: we recommend, when turning, that speed be decreased to gain better maneuverability.

PARKING BRAKE

The parking brake is activated by pressing the block lever located on the front wheel (pic.8 pos.D)

RELEASE BRAKE

To release the brake, completely push the above mentioned (pic.8 pos.E).

CLEANING THE FILTERS

Effective operation of the sweeper depends on the state of the filters which must be kept clean.

If the area to be cleaned is particularly dusty, filters must be shaken more often, at least every 5 minutes. To clean the filter, move the handle (pic.6 pos.E) up and down 4-5 times.

Note: please note that this kind of filter need to be cleaned every 2-3 fillings of the dirt container.

VACUUM CUT-OFF

When passing over wet floors it is necessary to cut off vacuum (fig.2 pos.B electric version, fig.4 pos.B Honda version)

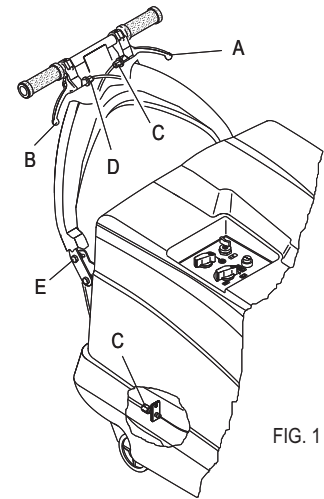

FIG. 1

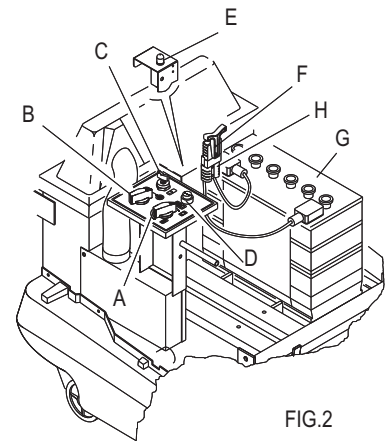

FIG. 2

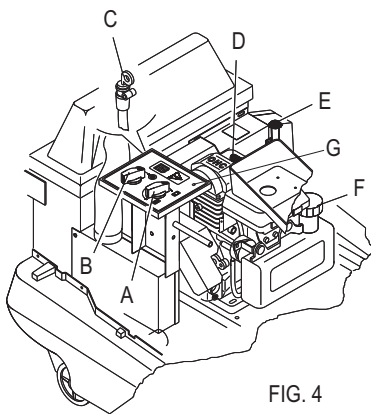

FIG. 4

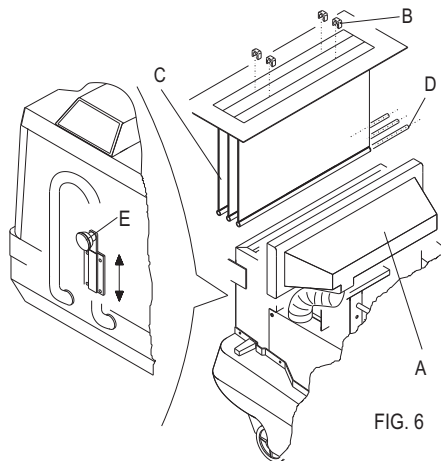

FIG. 6

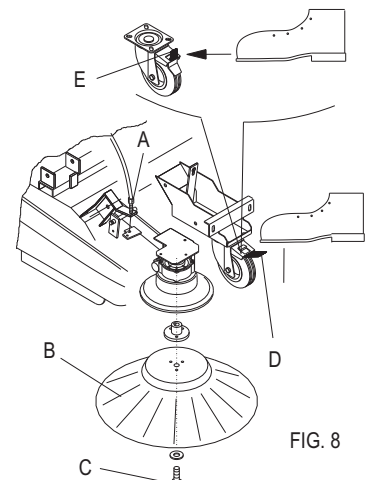

FIG. 8

"HONDA" MOTOR

ATTENTION!

For the maintenance and the correct use of the engine carefully read the original manual supplied by HONDA and strictly follow the instructions in it.

STOPPING THE ENGINE N°1

Keep pushed the switch (pic.4-pos. G) until the engine cuts out

STOPPING THE ENGINE N°2

Place the accelerator lever in "STOP" position

STARTING THE ENGINE

- Pull the choke rod (consult the "HONDA" manual)
- Place the accelerator lever in "MAX" position
- Pull the starter grip lightly until resistance is felt, then pull briskly
- If the choke rod has been pulled to the CLOSED position to start the engine, push it to the OPEN position as soon as the engine warms up enough to run smoothly

Note: the engine has been pre-set at 3100 rpm

For the replacement of engine oil, look the instruction and maintenance manual of HONDA engine.

ELECTRIC MOTOR

STARTING THE ENGINE

Turn the key in pos.1 (fig.2 pos.C)

STOPPING THE ENGINE

Turn the key in pos.0 (fig.2 pos.C)

HOW TO CHARGE BATTERIES

- Turn off the machine
- Remove the key from the switch and open the machine's hood
- Disconnect the plug (fig. 2 pos. F)
- Connect the battery charger's plug (fig. 2 pos. H)
- Charge the batteries to a level not above 1/10th of their capacity.
- Check level of electrolyte and top it up, if necessary, with water.
- When the batteries are charged, connect again the connector (fig. 2 pos. F)

BATTERY CHARGE INDICATOR (FIG.2 POS.D)

It monitors the level of charge of the battery. While the green led is on, you can sweep. When the yellow led gets on, you must take care to go to have the battery charged. When the red led gets on, you must immediately switch off the machine, because the battery, if further discharged, can get irreversibly damaged its structure.

WARNING!

- Batteries must be charged in ventilated places.
- The gas generated during charging operations may produce explosions when in presence of flames or sparks.
- The battery acid must not come in contact with eyes, skin, clothes, painted or zinc coated surfaces.
- Should this happen, wash off the acid with water.
- Do not lean metallic objects over the batteries.
- Remove all caps of the various battery cells before charging the battery.
- Do not top up with sulphuric acid.

PERIODIC MAINTENANCE

The operator must check:

- brush state, every 10 hours;
- filter state, every 30 hours;
- main brush adjustment, every 50 hours;
- traction adjustment, every 50 hours;

The authorised service center must check:

- belt tension, every 200 hours;

The authorised service center must replace:

- filter, 12-24 months;
- flaps, when worn out;
- brushes, when worn out;

Before servicing the machine, disconnect the machine from its power source:

- disconnect the spark plug lid (fig.4 pos. D) for Honda version
- disconnect the connector (fig. 2 pos. F) for electric version

MAIN BRUSH ADJUSTMENT

- Remove the dirt container (fig. 7 pos. A).
- Lift the front part of the machine up
- Adjust the brush by screws (fig. 7 pos. D)
- N.B. Turning the screw clockwise the brush get up.
- ADJUST THE PRESSURE OF THE BRUSH IN ORDER THAT THE CLEAN PATH DOESN'T GO OVER 55-60 MM (fig. 5).
- **WITH THE PADEL DRAWER, THE CLEAN PATH MUST BE 33-37 MM (MAX CURRENT DRAW ON SURFACE TO BE TREATED: 45A)**

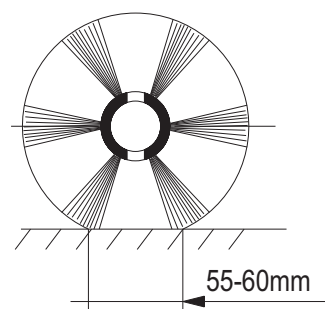

FIG. 5

REPLACING THE FILTER

- Open the hood
- Lift the filter cover (fig. 6 pos. A) up and leave it on the machine without removing the vacuum hose
- Remove clamps (fig. 6 pos. B)
- Extract the filter (fig. 6 pos. C)
- Unthread the 3 steel bars (fig. 6 pos. D) and insert them in the new filter
- Replace all the components removed

REPLACEMENT OF MAIN BRUSH

- Remove the dirt container (fig.7 pos. A)
- Lift the front part of the machine up
- Remove the 2 blocking screws of the brush (fig. 7 pos. B))
- Remove and replace the main brush but pay attention to the bristles (fig. 7 pos. C)
- Execute the adjustment in the way above mentioned

TECHNICAL CHART EB

MAIN SPECIFICATION	Cleaning path with side brush	780 mm
	Hourly performance with side brush	3.510 m ² /h
	Forward speed	0 - 4,5 km/h
	Dirt container capacity	40 L
	Maximum gradient	15 %
DIMENSIONS AND WEIGHT	Dimensions with side brush	1.555 x 835 x 980 mm
	Dimensions without side brush	1.320 x 735 x 980 mm
	Weight	91 kg
	Weight with type A batteries	127 kg
	Weight with type B batteries	131 kg
	Packaging dimensions	1.340 x 840 x 950 mm
	Packaging weight	33 kg
	Packaging volume	1,07 m ³
BRUSHES	Main brush dimensions	550 x Ø 265 mm
	Side brush diameter	450 mm
TRACTION SYSTEM	Traction type	Electronic
PRIMARY ELECTRIC MOTOR	Primary motor	12V - 600 W
	Power absorption (machine loaded)	45 A
TYPE A BATTERIES	Type	1 lead acid battery 12V 158A C20 - 110A C5
	Dimensions ea.	345 x 170 x 285 mm
	Autonomy (theoretical)	2 h
TYPE B BATTERIES	Type	1 gel battery 12V 105A C5
	Dimensions ea.	345 x 170 x 285 mm
	Autonomy (theoretical)	1 h 45 min
FILTER SYSTEM	Filter type	MultiPocket filter © L class
	Total surface area	2 m ²
WHEELS	Type of wheels	3, solid rubber, non-marking
	Wheels	Ø 125 mm front wheel, Ø 160 mm rear wheels
	Brakes	Mechanical, on front wheel
SOUND LEVEL (MEASURED ACCORDING TO ISO 11201)	Noise emission value LpA	74 dB (A)
	Uncertainty KpA	2.4 dB (A)
VIBRATION LEVEL	Whole-body vibration level aW	≤ 2.5 m/s ²
	Uncertainty K	-
TEMPERATURE RATING	Storage temperature	-20 / +50 °C
	Operating temperature	-20 / +50 °C

TECHNICAL CHART SH

MAIN SPECIFICATION	Cleaning path with side brush	780 mm
	Hourly performance with side brush	3.510 m ² /h
	Forward speed	0 - 4,5 km/h
	Dirt container capacity	40 L
	Maximum gradient	15 %
DIMENSIONS AND WEIGHT	Dimensions with side brush	1.555 x 835 x 980 mm
	Dimensions without side brush	1.320 x 735 x 980 mm
	Weight	98 kg
	Packaging dimensions	1.340 x 840 x 950 mm
	Packaging weight	33 kg
	Packaging volume	1,07 m ³
BRUSHES	Main brush dimensions	550 x Ø 265 mm
	Side brush diameter	450 mm
TRACTION SYSTEM	Traction type	Mechanical
ENGINE	Stroke engine	Honda 4,6 hp
FILTER SYSTEM	Filter type	MultiPocket filter © L class
	Total surface area	2 m ²
WHEELS	Type of wheels	3, solid rubber, non-marking
	Wheels	Ø 125 mm front wheel, Ø 160 mm rear wheels
	Brakes	Mechanical, on front wheel
SOUND LEVEL (MEASURED ACCORDING TO ISO 11201)	Noise emission value LpA	79 dB (A)
	Uncertainty KpA	2.4 dB (A)
VIBRATION LEVEL	Whole-body vibration level aW	4.99 m/s ²
	Uncertainty K	2.5 m/s ²
TEMPERATURE RATING	Storage temperature	-20 / +50 °C
	Operating temperature	-20 / +50 °C

TROUBLESHOOTING TABLE

ATTENTION!

ANY TYPE OF SERVICE OR TESTING, WITH THE EXCEPTION OF THOSE DESCRIBED IN THE ENGINE OR BATTERY MANUAL, MUST ONLY BE CARRIED OUT BY AN AUTHORISED SUPPORT CENTRE (ASC)

“HONDA” MOTOR

PROBLEM	CAUSE	SOLUTION
The engine smokes and is noisier than usual	Carburettor out of adjustment	Get the carburettor setting adjusted
	Exhaust pipe broken	Have it replaced
Dust inside the engine bonnet	Filters broken or worn out	Have it replaced
	Filter not well mounted	Check the assembly
The main brush doesn't clean uniformly and leaves material on the floor	Brush worn out	Have it replaced
	Not enough pressure on floor	Adjust the pressure
	Material has accumulated around brush	Remove it
The main brush doesn't turn	Belt broken	Have it replaced
	Belt loosen	Check belt tensioner
No suction when moving	Suction off	Switch it on
	Filters clogged	Shaker or replace them

ELECTRIC MOTOR

PROBLEM	CAUSE	SOLUTION
Battery won't charge	Motors overloaded because of extraneous fragments or seized bearings causing friction between moving parts	Remove foreign or change seized bearings
	Electrolyte density too low	Recharge the battery, have it replaced if necessary
Everything stays off when the key is inserted	Battery flat or faulty	Recharge or replaced it
	Cut out switch intervention	Engage the cut out switch
Dust inside the engine bonnet	Filters broken or worn out	Have it replaced
	Filter not well mounted	Check the assembly
The main brush doesn't clean uniformly and leaves material on the floor	Brush worn out	Have it replaced
	Not enough pressure on floor	Adjust the pressure
	Material has accumulated around brush	Remove it
The main brush doesn't turn	Belt broken	Have it replaced
	Belt loosen	Check belt tensioner
No suction when moving	Suction off	Switch it on
	Filters clogged	Shaker or replace them

SERVICE AND MAINTENANCE RECORDS

1°

SERVICE AND MAINTENANCE RECORD

UP TO 50 HOURS

DATE

DAY	MONTH	YEAR	WORK. HOURS

ELECTRIC VERSION	HONDA VERSION
<ul style="list-style-type: none"> <input type="checkbox"/> Clean with compressed air the external area of the motor, in particular the slots located in the rear part <input type="checkbox"/> Clean the part above the motor brushes and the manifold <input type="checkbox"/> Check the battery fluid level <input type="checkbox"/> Check the state of charge of each element 	<p>Before starting the cleaning check carefully, the machine and take care that there are no leaks of: fuel, oil, etc...</p> <p>Then open the bonnet and make the same checks for the engine.</p> <ul style="list-style-type: none"> <input type="checkbox"/> Air filter cartridge cleaning (code 590113) <input type="checkbox"/> Check the fuel pipes and the clamps

- Check the wear state and the ground track of brushes
- Check the main brush pressure
- Check the rubber flaps
- Check the hopper gaskets
- Check the correct functioning of the filter shaker lever
- Check the dust filter efficiency
- Check the tension of all the belts, and in case adjust them
- Check the functioning of all devices
- Test the machine

THE SERVICE WAS CARRIED OUT ON:

NAME:

SURNAME:

SIGNATURE:

STAMP OF DEALER WHO CARRIED OUT SERVICE

NOTES

2°

SERVICE AND MAINTENANCE RECORD

UP TO 100 HOURS

DATE

DAY	MONTH	YEAR	WORK. HOURS

ELECTRIC VERSION	HONDA VERSION
<input type="checkbox"/> Clean with compressed air the external area of the motor, in particular the slots located in the rear part <input type="checkbox"/> Clean the part above the motor brushes and the manifold <input type="checkbox"/> Check the battery fluid level <input type="checkbox"/> Check the state of charge of each element	<p>Before starting the cleaning check carefully, the machine and take care that there are no leaks of: fuel, oil, etc... Then open the bonnet and make the same checks for the engine.</p> <input type="checkbox"/> Air filter cartridge cleaning (code 590113) <input type="checkbox"/> Check the fuel pipes and the clamps

- Check the wear state and the ground track of brushes
- Check the main brush pressure
- Check the rubber flaps
- Check the hopper gaskets
- Check the correct functioning of the filter shaker lever
- Check the dust filter efficiency
- Check the tension of all the belts, and in case adjust them
- Check the functioning of all devices
- Test the machine

THE SERVICE WAS CARRIED OUT ON:

NAME:

SURNAME:

SIGNATURE:

STAMP OF DEALER WHO CARRIED OUT SERVICE

NOTES

SERVICE AND MAINTENANCE RECORDS

UP TO 200 HOURS AS FOR 50 HOURS DATE	DAY	MONTH	YEAR	WORK. HOURS
THE SERVICE WAS CARRIED OUT ON: NAME: SURNAME: SIGNATURE:	STAMP OF DEALER WHO CARRIED OUT SERVICE			

UP TO 300 HOURS AS FOR 100 HOURS DATE	DAY	MONTH	YEAR	WORK. HOURS
THE SERVICE WAS CARRIED OUT ON: NAME: SURNAME: SIGNATURE:	STAMP OF DEALER WHO CARRIED OUT SERVICE			

UP TO 400 HOURS AS FOR 50 HOURS DATE	DAY	MONTH	YEAR	WORK. HOURS
THE SERVICE WAS CARRIED OUT ON: NAME: SURNAME: SIGNATURE:	STAMP OF DEALER WHO CARRIED OUT SERVICE			

UP TO 500 HOURS AS FOR 100 HOURS DATE	DAY	MONTH	YEAR	WORK. HOURS
THE SERVICE WAS CARRIED OUT ON: NAME: SURNAME: SIGNATURE:	STAMP OF DEALER WHO CARRIED OUT SERVICE			

NOTES

SERVICE AND MAINTENANCE RECORDS

UP TO 600 HOURS AS FOR 100 HOURS DATE	DAY	MONTH	YEAR	WORK. HOURS
THE SERVICE WAS CARRIED OUT ON: NAME: SURNAME: SIGNATURE:	STAMP OF DEALER WHO CARRIED OUT SERVICE			

UP TO 700 HOURS AS FOR 200 HOURS DATE	DAY	MONTH	YEAR	WORK. HOURS
THE SERVICE WAS CARRIED OUT ON: NAME: SURNAME: SIGNATURE:	STAMP OF DEALER WHO CARRIED OUT SERVICE			

UP TO 800 HOURS AS FOR 300 HOURS DATE	DAY	MONTH	YEAR	WORK. HOURS
THE SERVICE WAS CARRIED OUT ON: NAME: SURNAME: SIGNATURE:	STAMP OF DEALER WHO CARRIED OUT SERVICE			

UP TO 900 HOURS AS FOR 400 HOURS DATE	DAY	MONTH	YEAR	WORK. HOURS
THE SERVICE WAS CARRIED OUT ON: NAME: SURNAME: SIGNATURE:	STAMP OF DEALER WHO CARRIED OUT SERVICE			

UP TO 1000 HOURS AS FOR 500 HOURS DATE	DAY	MONTH	YEAR	WORK. HOURS
THE SERVICE WAS CARRIED OUT ON: NAME: SURNAME: SIGNATURE:	STAMP OF DEALER WHO CARRIED OUT SERVICE			

NOTES

EU DECLARATION OF CONFORMITY

according to Annex II A of the Machinery Directive 2006/42/CE

The manufacturer that places this product on the market:

EUREKA S.p.A. Unipersonale
VIALE DELL'ARTIGIANATO 30/32, 35013 CITTADELLA (PD) - ITALY

formally declares that the product:

Sweeper KOBRA EB
Sweeper KOBRA SH

complies with the following EU Directives:

2006 / 42 / CE
2014 / 30 / UE
2014 / 35 / UE
2011/ 65 / UE + 2015 / 863
2009 / 125 / CE
2016/1628

Machinery Directive, Annex 1
Electromagnetic Compatibility (EMC) Directive
Low Voltage Directive
RoHS 3 Directive
Energy-Related Products (ErP) Directive
Regulation on the emission of gaseous and particulate pollutants from internal combustion engines intended for non-road mobile machinery

The following harmonised and technical standards have been applied:

EN ISO 12100:2010	Safety of machinery - General principles for design - Risk assessment and risk reduction.
EN 60335-1:2013	Household and similar electrical appliances - Safety - Part 1: General requirements.
EN 60335-2-72:2016	Household and similar electrical appliances - Safety - Part 2: Particular requirements for floor treatment machines with or without traction drive, for commercial use.
EN 55014-1:2019	Electromagnetic compatibility - Requirements for household appliances - electric tools and similar apparatus - Part 1: Emission.
EN 55014-2:2015	Electromagnetic compatibility - Requirements for household appliances, electric tools and similar apparatus - Part 2: Immunity - Product family standard.
EN 61000-6-2:2016	Electromagnetic compatibility (EMC) - Part 6-2: Generic standards - Immunity standard for industrial environments.
EN 61000-6-4:2018	Electromagnetic compatibility (EMC) - Part 6-4: Generic standards - Emission standard for industrial environments.
EN 62233:2008	Measurement methods for electromagnetic fields of household appliances and similar apparatus with regard to human exposure.

Legal representative and person authorized to compile the technical file: Antonio Barile

Cittadella, 15/12/2023

EUREKA S.p.A
(Legal representative)

